

Flange Buddy

The ideal aid for separating
piping flanges



saves time and money

FLANGE BUDDY

Application and Advantages

- Easy and safe mechanical separation of piping flanges.
- All parts manufactured with highest quality materials.
- **FLANGE BUDDY** is proven in international tests.

Operation instructions

Insert the **FLANGE BUDDY** in one of the bolt holes of a flange. Slip the bolt support plate, which is held by a chain, between the flange facings underneath the setscrew. Once the **FLANGE BUDDY** is jammed tight, continue turning with a wrench until a position is reached where a gasket can be replaced or a spade set. Then, slacken back the setscrew to the point where the support plate can be removed, and tap the setscrew with a hammer to free the **FLANGE BUDDY** from the bolt hole.

Recommend the use of two **FLANGE BUDDIES** in cases where the transfer of very great force is required. Insert the second **FLANGE BUDDY** in the corresponding hole of the companion flange. The force applied will act on the same support plate.

You will, thus, be able to apply heavy loads without risking damage to the support plate. Due to the flange proportions, it is not possible to increase the thickness of the support plate.

Do not load a plate on side while using great force!

Grease the threads well before using!

Warning:

To avoid serious injuries, never put your fingers between the separated flanges!

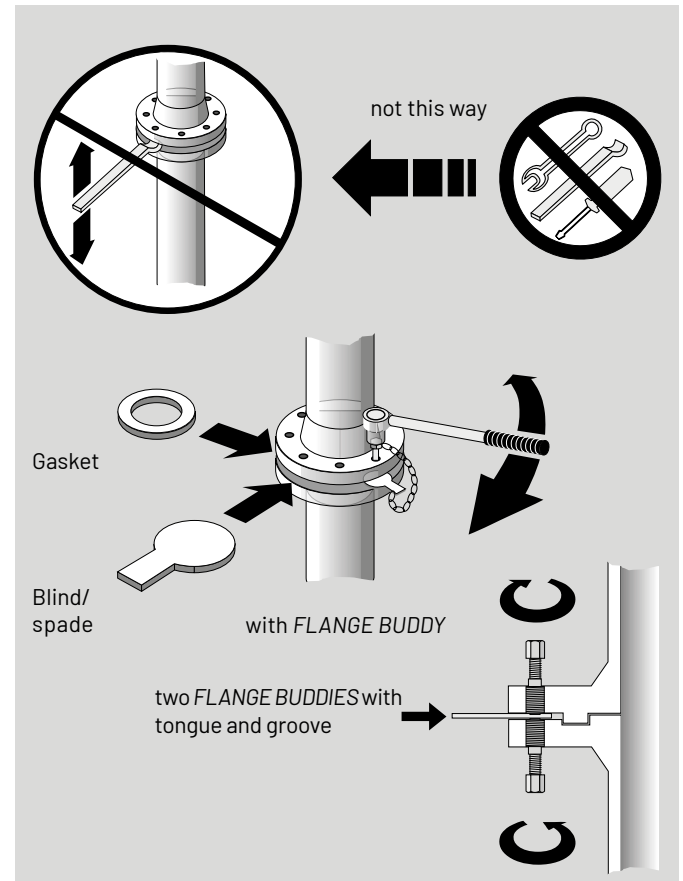

DIN Flange Dimensions (further sizes - upon request)

Type	Bolt hole (Ø mm)	PN 10 DN	PN 16 DN	PN 25 DN	PN 40 DN	PN 64 DN	PN 100 DN	PN 160 DN
D 18	18	32-125	32-125	32-80	32-80	20-25	20-25	20-25
D 22	22	150-350	150-200	100	100	32-80	32-40	32-40
D 26	26	400-500	250-300	125-200	125-150	100	50-80	50-80
D 30	30		400	250-350	200	125	100	100
D 33	33			350	250-300	150	150-175	125-150
D 36	36			400	350	200-300	200	200
D 39	39				400	350	250	
D 42	42					400	300	250-300

ANSI (ASA) Flange and British Standard Flange Dimensions (further sizes - upon request)

Type	Bolt hole (Ø mm)	150 lbs DN/Inch	300 lbs DN/Inch	600 lbs DN/Inch	900 lbs DN/Inch	1500 lbs DN/Inch
A 3/4	19	2, 2 1/2, 3, 4	3/4, 1, 2	3/4, 1, 1 1/4, 2		
A 7/8	22	5, 6, 8	1, 1 1/2, 2 1/2, 3, 4, 6	1 1/2, 2 1/2, 3	1/2, 3/4	1/2, 3/4
A 1	25	10, 12	8	4	1, 2, 3	1, 2
A 1 1/8	28	14, 16	10	6	1 1/2, 2 1/2	1 1/2, 2 1/2
A 1 1/4	32	18, 20	12, 14	8	4, 6	3
A 1 3/8	35	24	16, 18, 20	10, 12		4
A 1 1/2	38		14	8, 10, 12	6	
A 1 5/8	41		24	16	14	



Indispensable for separation of piping for DIN, ANSI (ASA) and B. Std. Flanges



DBP Nr. 2522817 • US Patent No. 4015324

alkitronic®
HOME OF TORQUE POWER

alkitronic® products
Made in Germany by
alki TECHNIK GmbH
Development, Production and
Distribution of Bolting Systems

Unterlettenweg 4
85051 Ingolstadt
Germany
fon +49 841 97499-0
fax +49 841 97499-90
info@alkitronic.com
www.alkitronic.com